

# one.click® Quick Guide

**saizen®**  
[somatropin (rDNA origin) for injection]

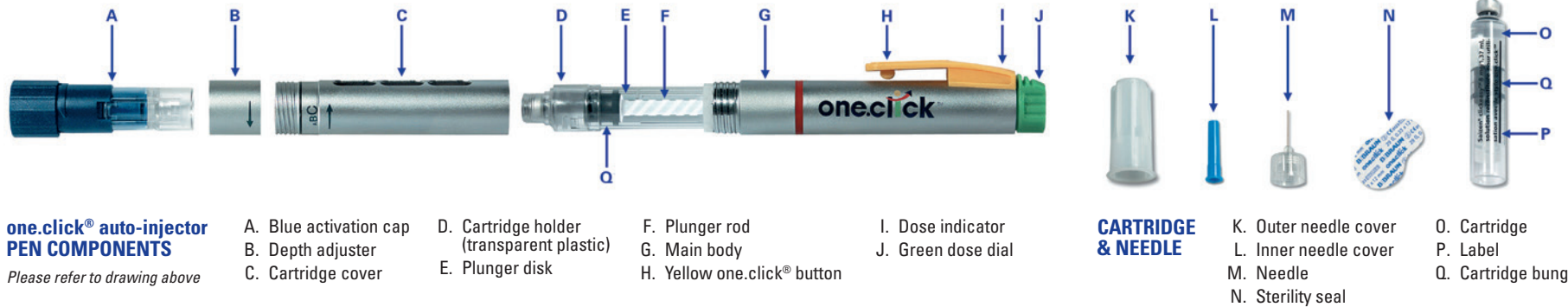

## Before you begin:

### You will need...

- ✓ one.click® instructions for use (IFU)
- ✓ one.click®
- ✓ Saizen® cartridge (if needed)
- ✓ new one.click® needle
- ✓ alcohol wipes
- ✓ sharps container

### Make sure to...

- ✓ Wash your hands with soap and water
- ✓ Use a clean towel to dry your hands
- ✓ Inspect Saizen® cartridge for damage
- ✓ Check medication expiration date

## Questions about one.click®?

Contact Patient Support Services  
**800-582-7989**

## Preparing one.click®

### INSTALLING/CHANGING CARTRIDGE

1. Unlock and remove the blue activation cap (component A, above) by twisting the cap counterclockwise. The depth adjuster (B) should remain attached to the cartridge cover (C) during the cartridge (O) installation procedure.

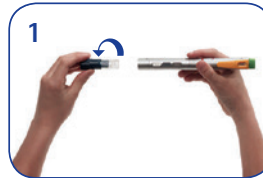

2. Unscrew the cartridge cover and then the cartridge holder (D). Ensure that the plunger rod comes back to baseline position (fully retracted into main body). If the plunger rod (F) does not come back to baseline position, push the plunger rod against a flat surface and it will move back inside the main body.



3. Remove the empty cartridge from the cartridge holder, if any.



**NOTE:** Clean the empty cartridge holder of your one.click® each time you change cartridges. Simply soak the empty cartridge holder in warm water for 10 minutes and let it dry in a vertical position.

Insert a new cartridge into the clean cartridge holder by inserting the top of the cartridge (silver cap) into the cartridge holder first.

4. Screw the cartridge holder with the cartridge back onto the one.click® main body.

Turn the cartridge holder clockwise until the disc on the plunger rod is against the cartridge bung (Q). When you hear a slight ratcheting sound, stop turning the cartridge holder.



**NOTE:** For an accurate injection it is very important that the disc on the plunger rod is properly positioned against the cartridge bung. Be sure to continue to turn the cartridge holder until you hear the ratcheting sound.

Screw the cartridge cover back onto the one.click® main body tightly.

### SETTING INJECTION DEPTH

Set the injection depth by turning the depth adjuster counterclockwise until the A, B or C is exposed or leave it in the starting position. Your healthcare provider will recommend the appropriate injection depth for you.

**NOTE:** See one.click® IFU, section 3 page 7, for more information.



# Injecting with one.click®

**saizen®**  
[somatropin (rDNA origin) for injection]

## ATTACH

You are now ready to carry out your injection by following the steps below:

5. Take a new needle (M) and remove the protective sterility seal (N). Use only the needles provided with your one.click®.

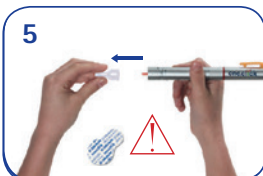

**WARNING:** Do not use the needle if the seal is damaged. Discard in an approved sharps disposal container and get a new needle.

Screw the new needle onto the cartridge holder and remove the outer needle cover (K). Do not remove the inner needle cover (L).

6. Place the color end of the blue activation cap on a flat, non-slip surface.



Without touching the yellow one.click® button (H), grip the one.click® on the cartridge cover and press down until a click is heard.

7. Remove the blue activation cap. It will automatically remove the inner needle shield. The inner needle shield is now lodged inside the blue activation cap.



Remove the inner needle shield from the blue activation cap by placing the clear end on a flat surface. Press the top of the blue activation cap down towards the flat surface and the inner needle shield will pop out.

## Taking care of your one.click®

1. Place your one.click® with the remaining mixed Saizen® in its storage box and refrigerate. The remaining mixed Saizen® must be used within 21 days. After 21 days, discard the cartridge.
2. Clean the cartridge holder each time you change cartridges. Soak the empty holder in warm water for 10 minutes and let it dry.
3. Clean one.click® with a damp cloth and mild soap if needed. Dry well. Do not immerse in water. Do not clean the metal threads.

## INJECT

8. Turn the green dose dial (J) clockwise slowly until the required dose appears in the dose indicator (I) window. If the green dose dial is accidentally turned past the required dose, turn the green dose dial counter-clockwise until the proper dose appears in the dose indicator window.

**CAUTION:** Never use force when adjusting the dose. If you have any problems setting the dose on your one.click®, see one.click® IFU "Additional Information" in Section V.

9. Select the injection site according to the instructions given by your healthcare provider. Clean the injection site with an alcohol swab. Let your skin dry before you inject your medication. Do not pinch the skin.

Hold the one.click® at a right angle against the skin.

Press the yellow one.click® button for the injection to start. You do not need to continue to press the yellow one.click® button. Keep the one.click® held against your skin for approximately 10 seconds. Ensure that the green dose dial rewinds to zero by looking for the "0" through the dose indicator window.

Lift up the one.click® from the skin. After the injection, if a drop of blood appears, simply press for a few seconds with a sterile gauze pad.

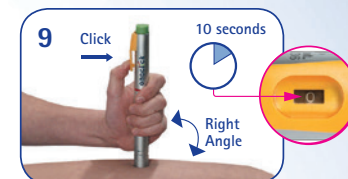
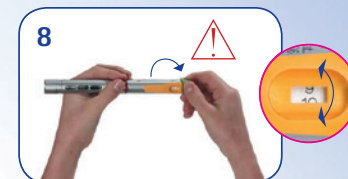

## DETACH

10. Cover the needle with the outer needle cover and unscrew it.

**IMPORTANT:** Dispose of the used needle and cap in an approved sharps disposal container.

Push and screw the blue activation cap back into the cartridge cover.

Place your one.click® with cartridge containing the remaining mixed solution of Saizen® in its storage box and immediately place the box back into the refrigerator (36-46°F / 2-8°C). Do NOT freeze. The cartridge containing the remaining mixed solution of Saizen® must be used within 21 days. After 21 days, discard the cartridge even if there is drug remaining in the cartridge.



**You're all done!**

**Contact Patient Support Services**

**800-582-7989**

Call for additional one.click® needles, and 24-hour product and device support